

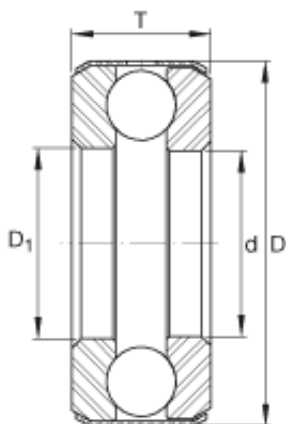

NSK bearing Trading Co., Ltd



INA B41 thrust ball bearings

Bearing No. B41

Size	82.55x126.21x28.58 mm
Bore Diameter	82,55 mm
Outer Diameter	126,21 mm
Width	28,58 mm
d	3 1/4 inch
d	82,55 mm
D	4,969 inch
D	126,21 mm
T	1,125 inch
T	28,58 mm
D ₁	3,281 inch
m	2,683 lbs / Weight
m	1,217 kg / Weight
C _a	22300 lbf / Dynamic load rating (axial)
C _a	99000 N / Dynamic load rating (axial)
C _{0a}	62000 lbf / Static load rating (axial)
C _{0a}	276000 N / Static load rating (axial)
Category	Thrust Ball Bearing
Inventory	0.0
Manufacturer Name	SCHAEFFLER GROUP
Minimum Buy Quantity	N/A
Weight / Kilogram	1.457
Product Group	B00308

B41 Bearing 2D drawings and 3D CAD models



NSK bearing Trading Co., Ltd

Rolling Element	Ball Bearing
Thrust Bearing	Yes
Single or Double Direction	Single Direction
Banded	Yes
Cage Material	Steel
Precision Class	ABEC 1 ISO P0
Component Description	Roller Assembly Plus Raceways
Other Features	Single Row With Flat Seat
Long Description	3-1/4" Bore 1; 3-9/32" Bore 2; 4-31/32" Outside Diameter; 1-1/8" Height; Ball Bearing; Single Direction; Banded; Steel Cage; ABEC 1 ISO P0 Precision
Inch - Metric	Inch
Category	Thrust Ball Bearings
UNSPSC	31171552
Harmonized Tariff Code	8482.10.50.08
Noun	Bearing
Keyword String	Ball Thrust
Manufacturer URL	http://www.ina.com
Overall Height with Aligning Washer	0 Inch 0 Millimeter
Bore 2	3.281 Inch 83.337 Millimeter
Height	1.125 Inch 28.575 Millimeter
Outside Diameter	4.969 Inch 126.213 Millimeter
Bore 1	3.25 Inch 82.55 Millimeter